

BENCH MARK: Runner 1441 on curb on West side of 30th Street City of San Bernardino, California South of Montgomery Ave. Elev. 123.34 (S.D. 20, P. 10)

BENCH MARK: USC 4.65 1522 1926 at S.E. corner of 30th St. and Waterman Ave. adjacent to fence. Elev. 123.34.

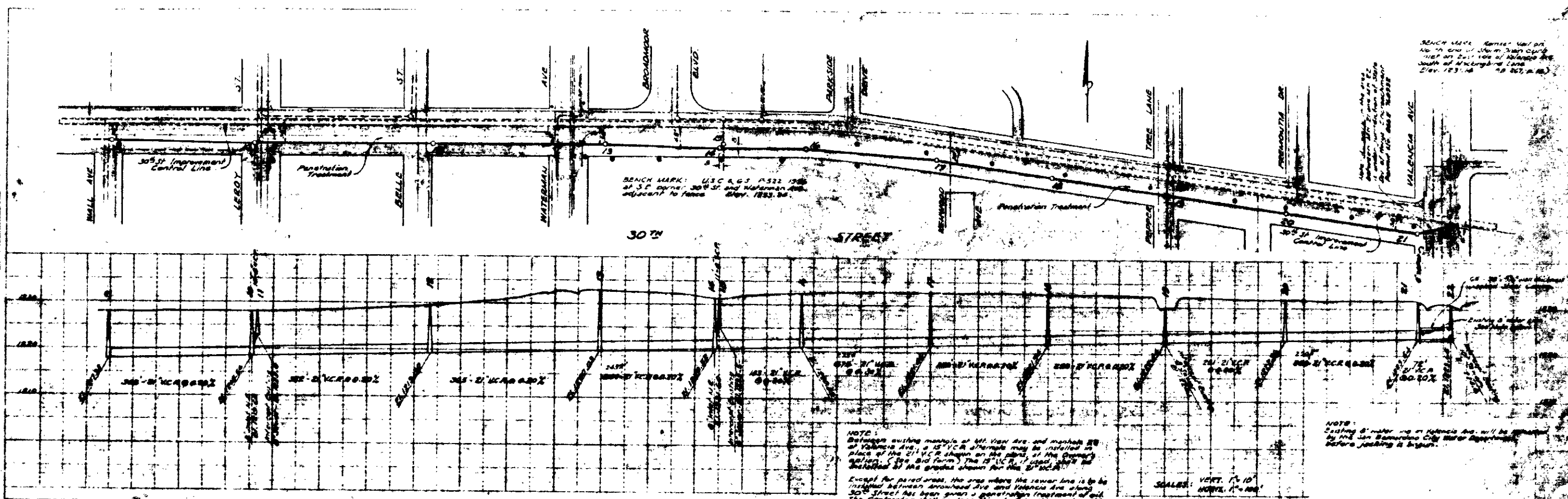

NOTE: Between existing manhole at Mt. View Ave. and manhole 28 at Valencia Ave., a 15' V.C.R. alternate may be installed in place of the 21' V.C.R. shown on the plan, at the property owner's expense. The 15' V.C.R. shall be installed at the grade shown for the 21' V.C.R.

NOTE: Except for penetration, the area where the sewer line is to be installed between Arrowhead Ave. and Valencia Ave. along 30th Street has been given a penetration treatment of soil. The contractor shall replace this soil of conditions where any existing damage of adjacent property.

SCALE: VERT. 1" = 10'
HORIZ. 1" = 100'

NOTE: Casing of water line at Valencia Ave. will be installed by the San Bernardino City Water Department before jacking is begun.

- LIST OF TERMINAL MANHOLES -

No.	Location	Elev.
1	Along N. of 12th St. - 420' N. of 6th St.	7.0
2	Along N. of 12th St. - 420' N. of 6th St.	7.0
3	Along N. of 12th St. - 420' N. of 6th St.	7.0
4	Along N. of Orange Way - 420' N. of 6th St.	7.0
5	Along N. of 20th St. - 420' N. of 6th St.	7.0
6	Along N. of 21st St. - 420' N. of 6th St.	7.0
7	Along N. of Highland Ave. - 420' N. of 6th St.	7.0
8	On 21st St. - 370' N. of 6th St.	6.1
9	On Casswell Ave. - 320' N. of 6th St.	5.2
10	On 5th St. - 160' N. of 6th St.	4.3
11	On 7th St. - 30' N. of 6th St.	3.4
12	On 12th St. - 120' N. of 6th St.	2.5
13	On Highland Ave. - 320' N. of 6th St.	1.6
14	On 12th St. - 120' N. of 6th St.	0.7
15	On Arrowhead Ave. - 420' N. of 6th St.	0.8
16	On Marching Ave. - 170' N. of 6th St.	0.9
17	On Mt. View Ave. N. Lane - 120' N. of 6th St.	1.0
18	On Mt. View Ave. S. Lane - 220' N. of 6th St.	1.1
19	On Riverside Dr. - 220' N. of 6th St.	1.2
20	On Serra Way - 520' N. of 6th St.	1.3
21	On Lombard Ave. - 220' N. of 6th St.	1.4
22	On 10th Ave. - 220' N. of 6th St.	1.5
23	On Leray St. - 220' N. of 6th St.	1.6
24	On Belle St. - 220' N. of 6th St.	1.7
25	Arrowhead Addition Date & Waterman Ave. - 120' N. of 6th St.	1.8
26	On Broadmead Blvd. - 420' N. of 6th St.	1.9
27	On Parkside Drive - 120' N. of 6th St.	2.0
28	On Parkside Drive - 120' N. of 6th St.	2.1
29	On Arrowhead Tree Lane - 120' N. of 6th St.	2.2
30	On Arrowhead Ave. - 120' N. of 6th St.	2.3
31	On Arrowhead Ave. - 120' N. of 6th St.	2.4
32	On Lago Ave. - 320' N. of 6th St.	2.5

NOTE: When a Terminal Manhole number is listed as a Bid Item, a new standard 48" diameter manhole shall be constructed over the existing sewer line at the specified location. The pipe breaks out and the hole plugged with brick and mortar.

When listed as a Bid Item to "Plug Existing Manhole", the Contractor shall install a brick and mortar plug in the hole of an existing manhole when directed by the Engineer. Locations requiring such plug are:

- Manhole 28 - 120' N. of 6th St.

Revision of these lateral squares is required at:

- Arrowhead 320' N. of 6th St. on E. side of Central St.

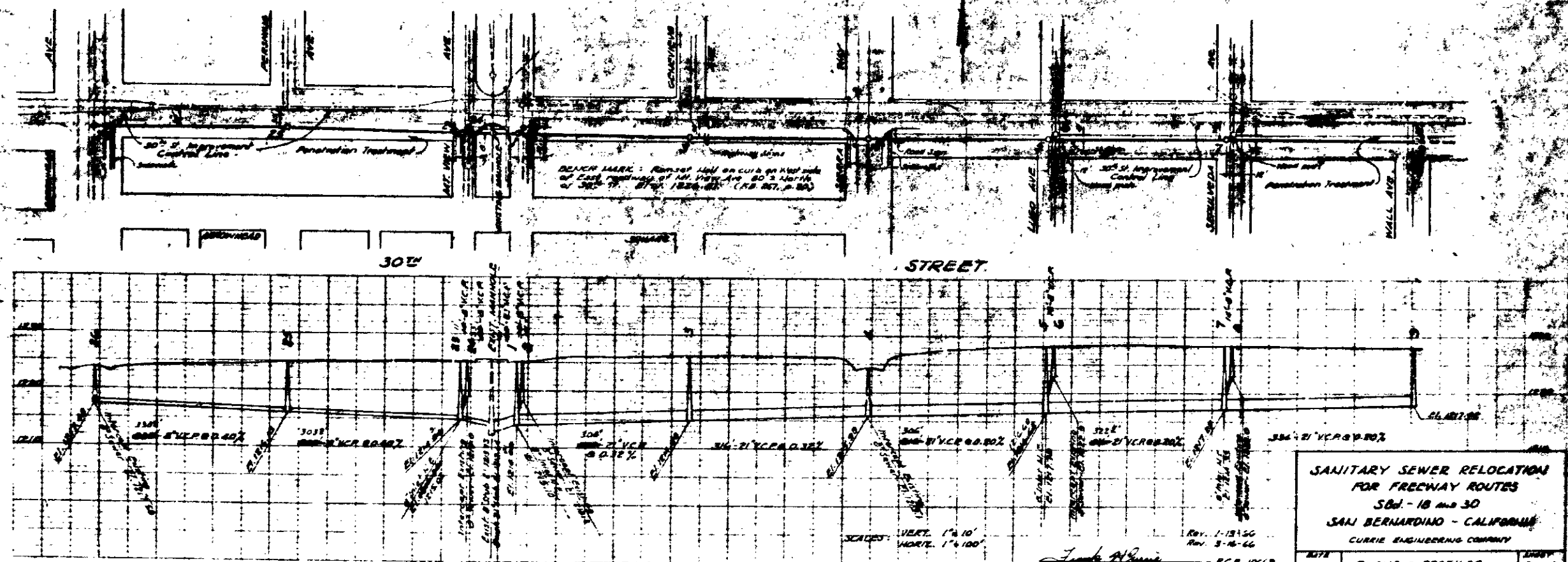

SCALE: VERT. 1" = 10'
HORIZ. 1" = 100'

Rev. 1-13-66
Rev. 3-6-66

John A. ...
RCE 10663

REVISED AS BUILT 3-10-66

**SANITARY SEWER RELOCATION
FOR FREEWAY ROUTES
S.D. - 18 and 30
SAN BERNARDINO - CALIFORNIA
CURRIE ENGINEERING COMPANY**

10-2-65 **PLANS & PROFILES** 2 of 3
PLAN No. 3334.

BENCH MARK: Runner Nail on top of curb on West side of 30th St. at intersection of Valencia Ave. South of Broadway Ave. Elev. 123.84 (S.D. 87, p. 10)

BENCH MARK: USC 4.65 1522 1926 at 3' E. corner of 30th St. and Mission Ave. adjacent to fence Elev. 123.84

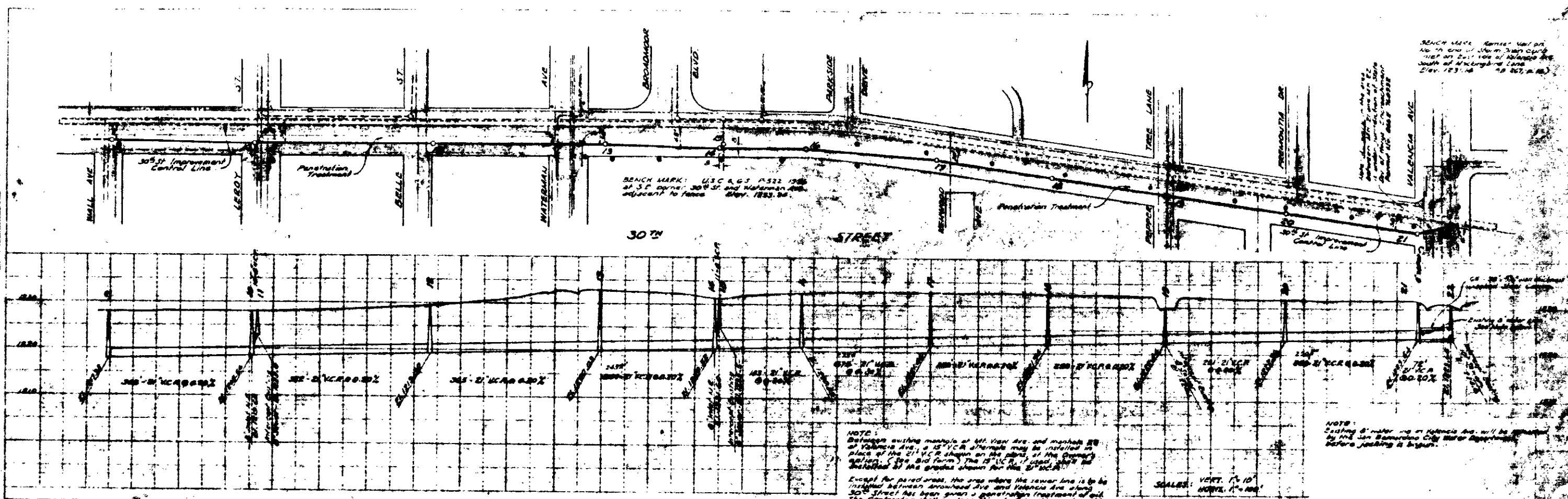

NOTE: Between existing manholes at Mission Ave. and manhole 28 at Valencia Ave. a 15" V.C.R. alternate may be installed in place of the 24" V.C.R. shown on the plan at the property address of 28 and 29. The 15" V.C.R. shall be installed at the grade shown for the 24" V.C.R.

Except for penetration, the area where the sewer line is to be installed between Broadway Ave. and Valencia Ave. along 30th Street has been given a penetration treatment of soil. The contractor shall replace this soil of openings where he requires change of return flow.

NOTE: Casing of water line at Valencia Ave. will be installed by the San Bernardino City Water Department before jacking is begun.

SCALE: VERT. 1" = 10'
HORIZ. 1" = 100'

- LIST OF TERMINAL MANHOLES -

No.	Location	Elev.
1	Along N. of 12th St. - 420' N. of 6th St.	7.0
2	Along N. of 12th St. - 420' N. of 6th St.	7.0
3	Along N. of 12th St. - 420' N. of 6th St.	7.0
4	Along N. of Canyon Way - 420' N. of 6th St.	7.0
5	Along N. of 20th St. - 420' N. of 6th St.	7.0
6	Along N. of 24th St. - 420' N. of 6th St.	7.0
7	Along N. of Highland Ave. - 420' N. of 6th St.	7.0
8	On 24th St. - 370' N. of 6th St.	6.1
9	On Casswell Ave. - 320' N. of 6th St.	5.8
10	On 5th St. - 160' N. of 6th St.	5.8
11	On 7th St. - 30' N. of 6th St.	5.8
12	On 12th St. - 220' N. of 6th St.	5.8
13	On Highland Ave. - 320' N. of 6th St.	5.8
14	On 12th St. - 150' N. of 6th St.	5.8
15	On Broadway Ave. - 420' N. of 6th St.	5.8
16	On Marching Ave. - 170' N. of 6th St.	5.8
17	On 1st Street N. Lane - 120' N. of 6th St.	6.0
18	On 1st Street S. Lane - 220' N. of 6th St.	6.0
19	On Riverside St. - 220' N. of 6th St.	6.0
20	On Santa Way - 590' N. of 6th St.	5.8
21	On Lombard Ave. - 220' N. of 6th St.	5.7
22	On 10th Ave. - 220' N. of 6th St.	5.8
23	On Lacey St. - 220' N. of 6th St.	5.7
24	On Belle St. - 220' N. of 6th St.	5.7
25	Between 1st Street N. Lane & Mission Ave. - 120' N. of 6th St.	5.8
26	On Broadway Ave. - 420' N. of 6th St.	5.8
27	On Riverside Drive - 120' N. of 6th St.	6.0
28	On Highland Ave. - 120' N. of 6th St.	6.0
29	On Apple Tree Lane - 120' N. of 6th St.	6.0
30	On Newport Ave. - 75' N. of 6th St. 1/2 mile S.W. Blvd.	7.0
31	On Alameda Ave. - 120' N. of 6th St. 1/2 mile S.W. Blvd.	6.3
32	On Lugo Ave. - 320' N. of 6th St.	6.8

NOTE: When a Terminal Manhole number is listed as a Bid Item, a new Manhole & 8" diameter manhole shall be constructed over the existing sewer line at the specified location. The pipe breaks out and the hole plugged with brick and mortar.

When listed as a Bid Item to "Plug Existing Manhole" the Contractor shall place a brick and mortar plug in the hole of an existing manhole when directed by the Engineer. Locations requiring such plug are:

- Manhole 28 - 420' N. of 6th St.

Revision of these lateral squares is required at:

- Approx. 320' N. of 6th St. on E. side of Central St.

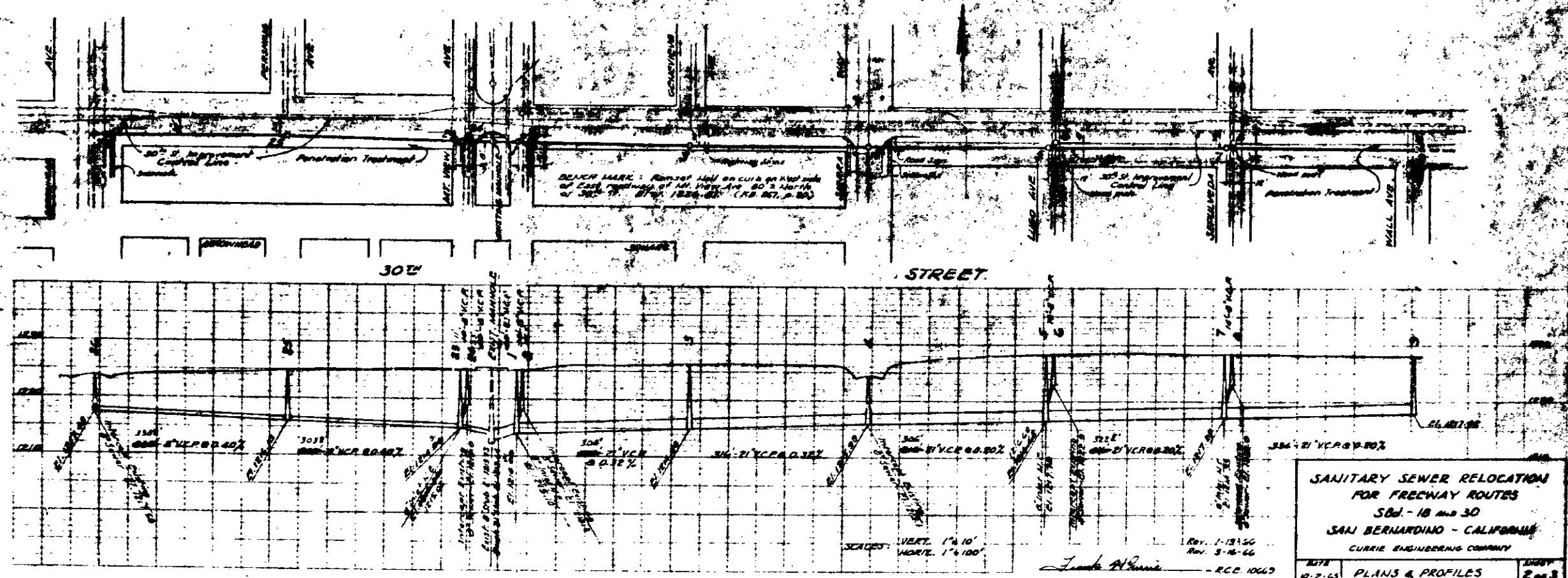

**SANITARY SEWER RELOCATION
FOR FREEWAY ROUTES
S.D. - 18 and 30
SAN BERNARDINO - CALIFORNIA**

CURRIE ENGINEERING COMPANY

Rev. 1-13-66
Rev. 3-6-66

10-2-65 PLAN & PROFILES

REVISIONS

REVISED AS BUILT 3-10-66

PLAN No. 3334